

### TECHNICAL FEATURE

#### FEATURES

- Space Qualified
- 1.6265 - 1.6605 GHz
- 4 - Way

### PRINCIPAL SPECIFICATIONS

Model Number	Frequency Range GHz	Isolation dB Min.	Insertion Loss, dB Max.	Phase Balance Max.	Amplitude Balance dB Max.	VSWR Max.		CW Input, W, Load VSWR out 1.2:1	Weight Max.
						In	Out		
PDM-41-1.64G SQ	1.6265 - 1.6605	20	0.5	±5°	0.3	1.15:1	1.15:1	1	90 g.

### TECHNICAL DESCRIPTION / APPLICATION

The PDM-41-1.64G SQ In-Phase Power Divider covers 1.6265 - 1.6605 GHz. It uses a stripline design which provides high isolation and low VSWR. This unit has been designed, manufactured, and qualified per Merrimac document CENG-0001, "Standard Design Requirements for Space Qualified Devices."

### PACKAGE OUTLINE

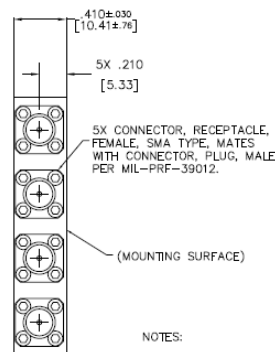
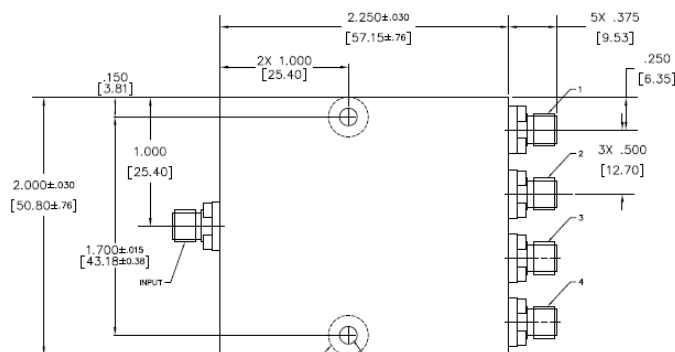

MOUNTING HOLE MUST BE FREE FROM PAINT  $\phi$ .31 [7.87mm] AROUND HOLE. MASKING DIA. MUST BE CONCENTRIC TO WITHIN  $\phi$ .020 [51mm] OF MTG. HOLE.

2X  $\phi$ .138±.003 [2.64±0.08] (MOUNTING HOLES)

#### NOTES:

1. TOLERANCE ON 3 PLACE DECIMALS  $\pm$ .020 [51mm] EXCEPT WHERE NOTED.
2. MAX. IS LARGEST DIMENSION ALLOWED.
3. DIMENSIONS = INCHES [mm]
4. METRIC EQUIVALENTS ARE TO THE NEAREST .01mm
5. EXTERNAL FINISH:  
EXTERIOR SURFACES: FLAT BLACK POLYURETHANE COATING AEROGLAZE Z306 (EXCEPT MOUNTING SURFACE TOP MOUNTING HOLE AREA AND AREA AROUND VENT HOLES AND VENT SLOT).  
MOUNTING AND UNPAINTED SURFACE FINISH: CHEMICAL FILM PER MIL-DTL-5541, CLASS 3.  
CONNECTOR FINISH: PASSIVATED.
6. WEIGHT: 3.18 OZ. [90g] MAX.